

## LOADING INSTRUCTIONS

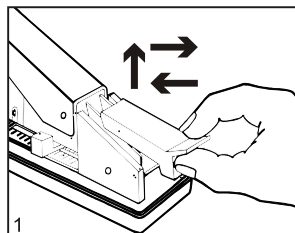

- Remove pusher assembly by pushing it forward, lift & pull the same.

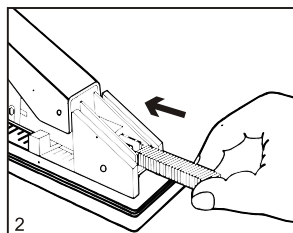

- Insert a strip of 100 staples.

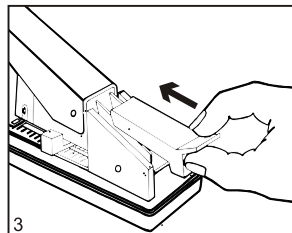

- Re-place pusher assembly.

## JAMMED STAPLE CLEARING MECHANISMS

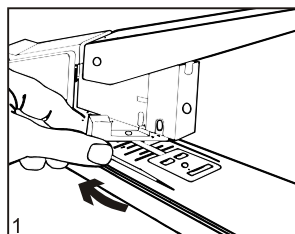

- Turn paper adjuster at 90 degrees.

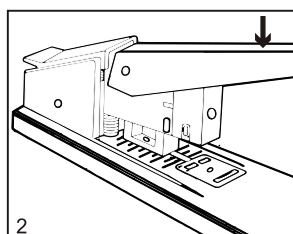

- Make a blank stapling. The jammed staple will be cleared.

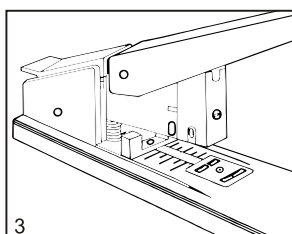

- Bring the paper adjuster to its original position.

## SPECIFICATIONS

FEATURES	DS-12S
Throat Depth	75 mm
Loading Capacity	100 Staples
Dimensions (LxWxH)	370X80X210 mm
Weight	1700 gms (Approx.)

### CAUTION

- KEEP YOUR FINGERS AWAY FROM THE PART WHERE STAPLES ARE COMING OUT. IT MAY CAUSE INJURY.

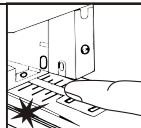

- DO NOT STAPLE WITHOUT PAPERS TO AVOID JAMMING.

- USE PROPER STAPLES.

\* The specifications of our products are subject to change without prior notice because of our continuous efforts to improve the quality.

**SALCO**  
STAPLE HEADQUARTERS®

**HEAVY DUTY STAPLER**

INSTRUCTION  
MANUAL

DS-12S



## SELECT STAPLES TO BE USED

NO. OF SHEETS* / THICKNESS	LEG LENGTH	STAPLE USE
2~30 / 3 mm	6 mm	23/6
25~50 / 5 mm	8 mm	23/8
30~70 / 7 mm	10 mm	23/10
50~100 / 9 mm	13 mm	23/13
70~120 / 11 mm	15 mm	23/15
90~160 / 13 mm	17 mm	23/17

\*Copy Paper

## VIEWING SLOT FOR LEG LENGTH OF STAPLES

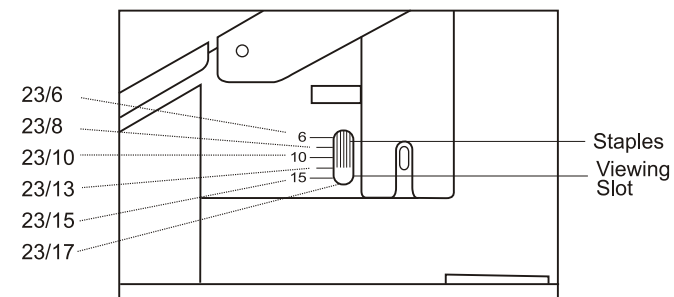

## SELECT CLINCHER FOR EACH STAPLE USE

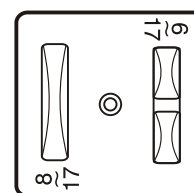

- Dual Clincher Life for 23/8 ~ 23/17 Staples

## TURN CLINCHER AS SHOWN

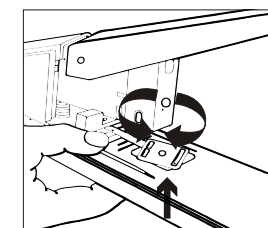

- Choose & load staples as per number/thickness of papers to be stapled & rotate the clincher accordingly.

## ASSEMBLY DETAILS FOR DS-12S STAPLER

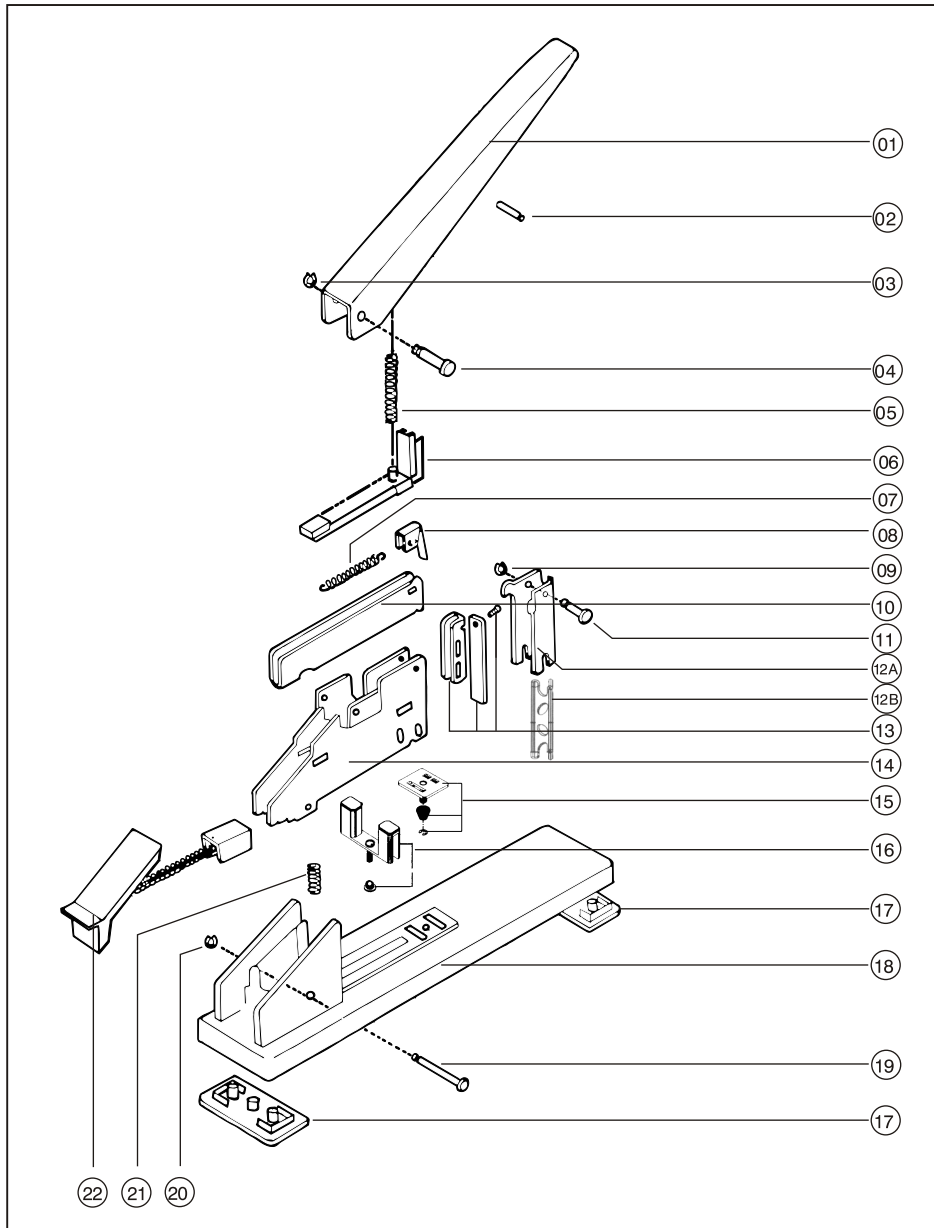

## PART LIST FOR DS-12S STAPLER

S.NO.	DESCRIPTION OF PARTS	ORDER CODE
01	HANDLE - UNIT	KC- 12S/17 -231
02	PARALLEL PIN	KC- 12S/17 -211
03	E-RING	KC- 12S/17 -301
04	STEP PIN	KC- 12S/17 -171
05	COMPRESSION SPRING	KC- 12S/17 -191
06	STAPLE COVER	KC- 12S/17 -161
07	EXPANSION SPRING	KC- 12S/17 -081
08	FRONT MAGAZINE COVER	KC- 12S/17 -271
09	E-RING	KC- 12S/17 -321
10	STAPLES GUIDE	KC- 12S/17 -041
11	STEP PIN	KC- 12S/17 -311
12A	MAGAZINE COVER	KC- 12S/17 -261A
12B	FRONT BRACKET	KC- 12S/17 -261B
13	DRIVER UNIT	KC- 12S/17 -251
14	MAGAZINE	KC- 12S/17 -181
15	CLINCHER UNIT	KC- 12S/17 -121
16	ADJUSTER UNIT	KC- 12S/17 -071
17	RUBBER FEET	KC- 12S/17 -021
18	BASE	KC- 12S/17 -011
19	STEP PIN	KC- 12S/17 -031
20	E-RING	KC- 12S/17 -291
21	COMPRESSION SPRING	KC- 12S/17 -051
22	PUSHER UNIT	KC- 12S/17 -091

Important : All spares available at nominal price.